



TCP 2 - PARADE MAP



	Contractor Name:	TCP #	Date:
	City of Chilliwack	TCP 2 of 4	June 3rd, 2017 10am - 11am
Job Description:			
Yarrow Days Parade			
Traffic Supervisor Contact:	Phone:	Email:	
Angella Fox	604-858-7730	Angella@StreetwiseTraffic.ca	
Traffic Plan Contact:	Phone:	Email:	
Tehjay Fox	604-799-8750	Tehjay@StreetwiseTraffic.ca	

TRAFFIC CONTROL PLAN
DATE OF LAST REVISION
2017-03-06

LEGEND	
	TRAFFIC CONTROL PERSONNEL
	SIGN STAND (TRIPOD)
	SIGN STAND (WINDMASTER)
	SIGN FLASHES
	CLASS 1 BARRICADE
	WORKZONE
	PARADE VOLUNTEERS
	TUBULAR MARKER - TYPE D
	TRAFFIC CONTROL VEHICLE
	FLASHING ARROW BOARD (FAB)
	EXISTING BUS STOP CLOSED
	RELOCATED BUS STOP

DRAWING SPECIFIC NOTES

- TCP's will assist residents to and from driveways if necessary
- TCP's will assist pedestrians around the workzone

GENERAL NOTES

- All traffic control shall conform to the TCM and the latest catalogue for Standard Traffic Signs
- Signs shown are representations of signs only and the MOTI Construction Sign Catalogue should be used for detailed sign design
- Dimensions shown are in meters and are the minimums except as otherwise indicated
- All permanent signage that will conflict with this site will be covered or removed while the works are in effect
- Active Work Zones and Hazards shall be delineated to protect workers and the travelling public
- Maximum distance between cones/delineator/barrel should be 10m
- Tubular markers and signs will be double based and well secured during windy conditions
- Distances may be adjusted due to urban block length



TCP 1 - OVERVIEW / DETOUR MAP

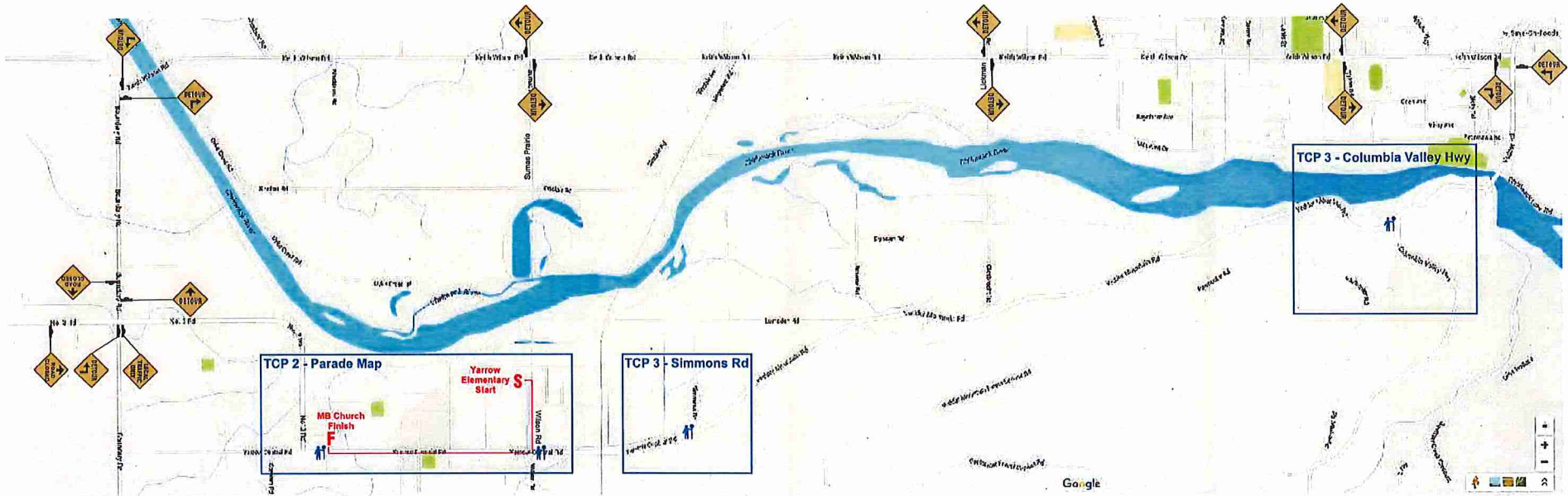

Contractor Name:	TCP #	Date:
City of Chilliwack	TCP 1 of 4	June 3rd, 2017 10am - 11am
Job Description: Yarrow Days Parade		
Traffic Supervisor Contact:	Phone:	Email:
Angella Fox	604-858-7730	Angella@StreetwiseTraffic.ca
Traffic Plan Contact:	Phone:	Email:
Tehjay Fox	604-799-6750	Tehjay@StreetwiseTraffic.ca

TRAFFIC CONTROL PLAN
DATE OF LAST REVISION
2017-03-06

LEGEND	
	TRAFFIC CONTROL PERSONNEL
	SIGN STAND (TRIPOD)
	SIGN STAND (WINDMASTER)
	SIGN FLAGS
	CLASS 1 BARRICADE
	WORKZONE
	TRAFFIC BARREL
	TUBULAR MARKER - TYPE D
	TRAFFIC CONTROL VEHICLE
	FLASHING ARROW BOARD (FAB)
	EXISTING BUS STOP CLOSED
	RELOCATED BUS STOP

DRAWING SPECIFIC NOTES

- TCP's will assist residents to and from driveways if necessary
- TCP's will assist pedestrians around the workzone

GENERAL NOTES

- All traffic control shall conform to the TCM and the latest catalogue for Standard Traffic Signs
- Signs shown are representations of signs only and the MOTI Construction Sign Catalogue should be used for detailed sign design
- Dimensions shown are in meters and are the minimums except as otherwise indicated
- All permanent signage that will conflict with this site will be covered or removed while the works are in effect
- Active Work Zones and Hazards shall be delineated to protect workers and the travelling public
- Maximum distance between cones/delineator/barrel should be 10m
- Tubular markers and signs will be double banded and well secured during windy conditions
- Distances may be adjusted due to urban block length



TCP 3 - Simmons Rd



TCP 4 - Columbia Valley Hwy

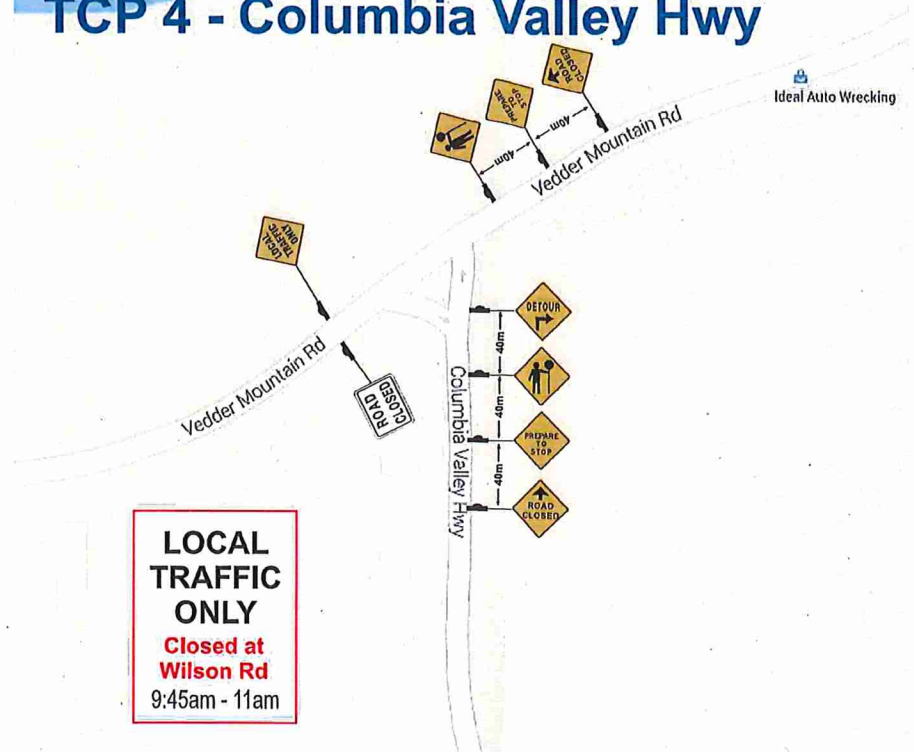

Streetwise
TRAFFIC CONTROLLERS™

TRAFFIC PLAN

TRAFFIC CONTROL PLAN
DATE OF LAST REVISION
2017-03-06

Contractor Name:	TCP #	Date:
City of Chilliwack	TCP 3 & 4 of 4	June 3rd, 2017 10am - 11am
Job Description: Yarrow Days Parade		
Traffic Supervisor Contact:	Phone:	Email:
Angella Fox	604-858-7730	Angella@StreetwiseTraffic.ca
Traffic Plan Contact:	Phone:	Email:
Tehjay Fox	604-799-6750	Tehjay@StreetwiseTraffic.ca

LEGEND	
	TRAFFIC CONTROL PERSONNEL
	SIGN STAND (TRIPOD)
	SIGN STAND (WINDMASTER)
	SIGN FLASHES
	CLASS 1 BARRICADE
	WORKZONE
	TRAFFIC BARREL
	TUBULAR MARKER - TYPE D
	TRAFFIC CONTROL VEHICLE
	FLASHING ARROW BOARD (FAB)
	EXISTING BUS STOP CLOSED
	RELOCATED BUS STOP

DRAWING SPECIFIC NOTES

- All traffic control shall conform to the TCM and the latest catalogue for Standard Traffic Signs
- TCP's will assist residents to and from d-tweys if necessary
- TCP's will assist pedestrians around the workzone

GENERAL NOTES

- All permanent signage that will conflict with this site will be covered or removed while the works are in effect
- Active Work Zones and Hazards shall be delineated to protect workers and the travelling public
- Maximum distance between cones/tubular marker should be 10m
- Tubular markers and signs will be double based and well secured during windy conditions
- Distances may be adjusted due to urban block length